

Diaphragm Valve Type 317

Standard Features

- **Size**
1/2"–6"
- **Valve Body Material**
PVC, CPVC, PROGEF Standard
Polypropylene, SYGEF PVDF
- **Diaphragm Material**
EPDM, PTFE, FPM, NBR, or Hypalon
- **Connection**
ANSI flange
- **Pressure rating**
150 PSI
- **Easy replacement of diaphragm**

Optional Features

- **Pneumatic actuation**
- **Lockable handle (1/2"–2 1/2")**
- **Connection**
ISO/DIN flanged connection
Union connection (1/2"–2")
Spigot connection (1/2"–2")



General

The Type 317 diaphragm valve incorporates a robust design with several options for wetted materials. Diaphragms are available in EPDM, PTFE, FPM, NBR, or Hypalon. The valve body is available in PVC, CPVC, PP, and PVDF, allowing the valve to handle most chemical applications. In addition to being chemically resistant, the GF diaphragm valves are often the best solution for applications where particulates are present. The flanged connections allow for easy repair or replacement in the field.

Diaphragm Valve Type 317

Pressure-Temperature Diagrams

The following pressure temperature diagrams are based on a lifetime of 25 years and the medium water or similar media.

Remark: At temperatures below 0°C, please check the torque of the bolts of the membrane according to the recommended values after the system is in use.

PP

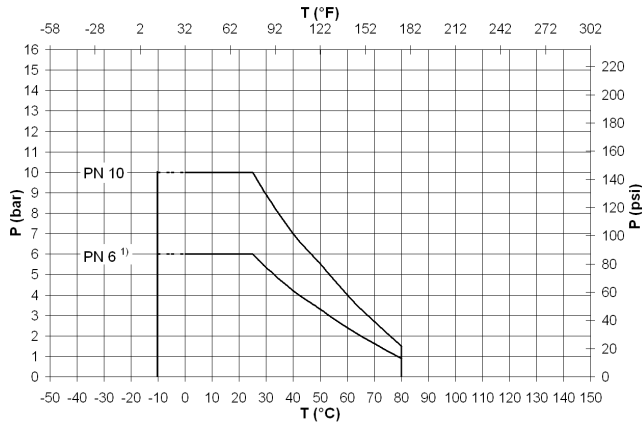

- 1) 4" and 6" flanged
- p Permissible pressure in bar, psi
- T Temperature in °C, °F

In case of applications with temperatures in the range of the dotted lines, please contact your GF representative.

PVC

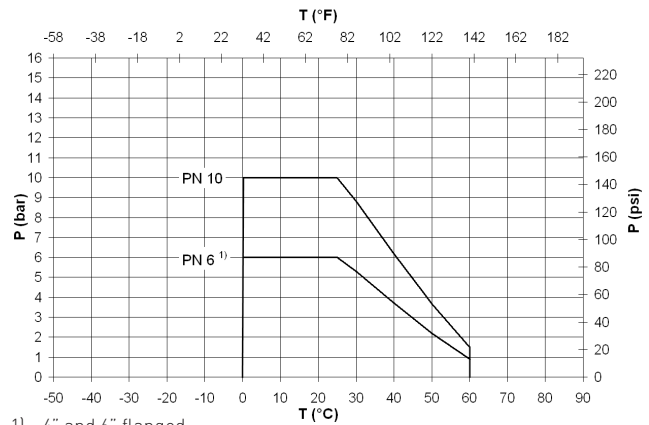

- 1) 4" and 6" flanged
- p Permissible pressure in bar, psi
- T Temperature in °C, °F

PVDF

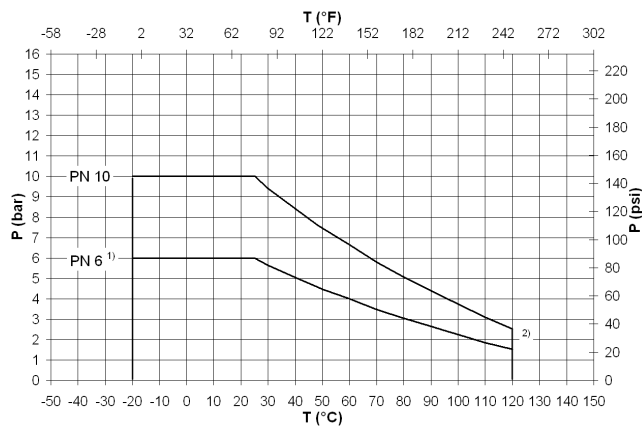

- 1) 4" and 6" flanged
- p Permissible pressure in bar, psi
- T Temperature in °C, °F

CPVC

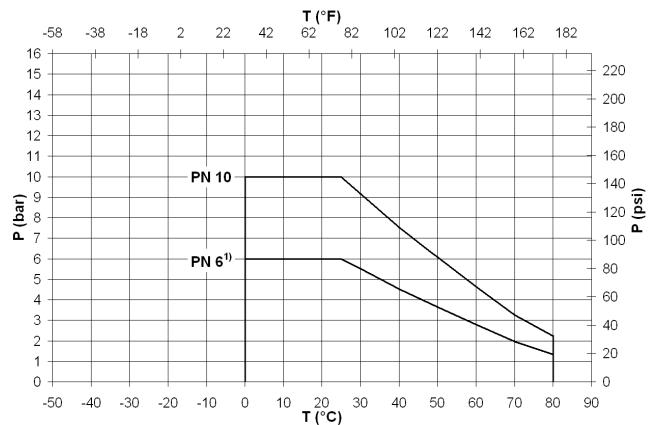

- 1) 4" and 6" flanged
- p Permissible pressure in bar, psi
- T Temperature in °C, °F

Diaphragm Valve Type 317

Technical Data

Operating Torque (average values)

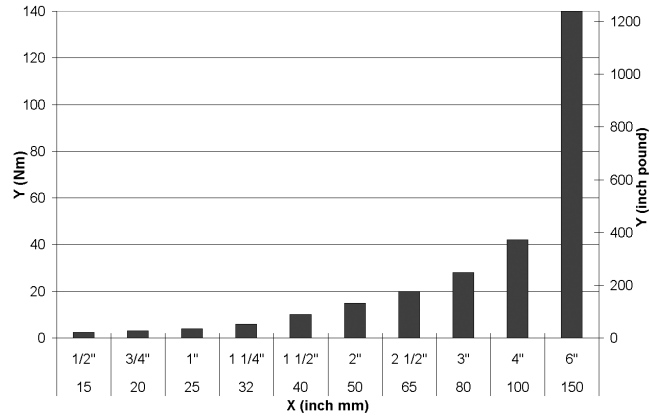

X Size DN (mm, inch)
Y Torque (Nm, inch pound)

Flow Characteristics

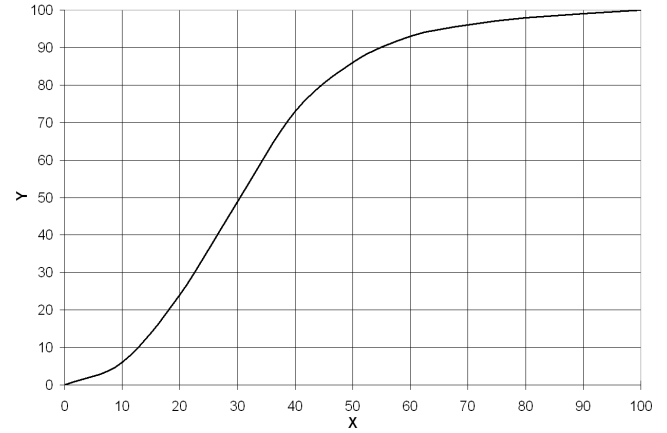

X Lift (%)
Y Flow factor kv, cv (%)

Pressure Loss

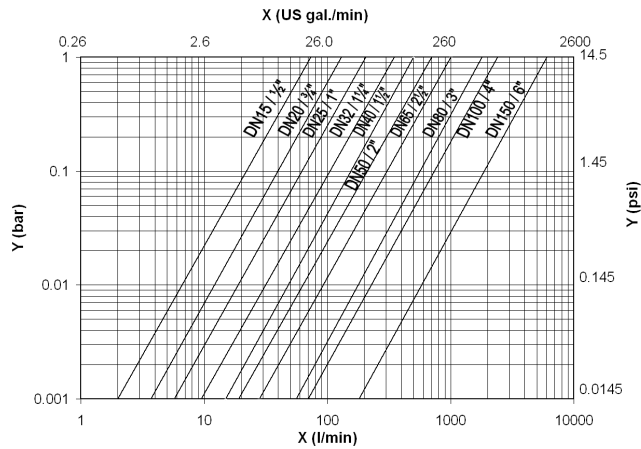

X Flow rate (l/min, US gal/min)
Y Pressure loss Δp (bar, psi)

Cv Values

The Cv values for each intermediate valve position can be determined using the flow value characteristic and the Cv values.

DN inch	d mm	kv 100 l/min ($\Delta p=1$ bar)	Cv US gal/min ($\Delta p=1$ psi)	kv 100 m ³ /h ($\Delta p=1$ bar)
1/2	20	72	5.0	4.3
3/4	25	137	9.6	8.2
1	32	207	14.5	12.4
1 1/4	40	354	24.8	21.2
1 1/2	50	517	36.2	31.0
2	63	713	49.9	42.8
2 1/2	75	992	69.5	59.5
3	90	1700	119.0	102.0
4	110	2700	189.0	162.0
6	160	6033	422.3	362.0

Dimensions for Type 317 Diaphragm Valve

Inch size	A inch	B CPVC inch	B PVC/PP/PVDF inch	D inch	E CPVC inch	E PVC/PP/PVDF inch	H inch	L PVC/PP/PVDF inch	L CPVC inch	M inch	I inch	No. bolt holes	F inch	K* mm	T inch	Lift inch
1/2	0.55	3.50	3.74	3.15	0.50	0.43	3.54	5.12	5.91	2.38	0.55	4	0.98	M6	0.47	0.31
3/4	0.69	3.88	4.13	3.15	0.50	0.47	4.02	5.91	6.54	2.75	0.55	4	0.98	M6	0.47	0.43
1	0.83	4.25	4.53	3.70	0.56	0.55	4.67	6.30	7.09	3.13	0.55	4	0.98	M6	0.47	0.51
1 1/4	1.00	4.63	5.51	4.61	0.63	0.59	4.96	7.09	7.56	3.50	0.71	4	1.77	M8	0.59	0.63
1 1/2	1.28	5.00	5.91	4.61	0.69	0.63	5.47	7.87	8.27	3.88	0.71	4	1.77	M8	0.59	0.83
2	1.53	6.00	6.50	5.98	0.75	0.71	6.77	9.06	9.06	4.75	0.71	4	1.77	M8	0.59	1.10
2 1/2	1.81	7.28	7.28	5.98	0.79	0.79	7.91	11.42	11.42	5.50	0.71	4	2.76	M8	0.59	1.18
3	2.24	7.87	7.87	10.63	1.38	1.38	10.43	12.20	12.20	6.00	0.71	4	4.72	M12	0.91	1.57
4	2.72	8.86	8.86	10.63	1.38	1.38	11.97	13.78	13.78	7.50	0.71	8	4.72	M12	0.91	1.97
6	4.25	—	11.22	15.75	—	1.38	17.20	18.90	—	9.50	0.87	8	3.94	M12	0.91	2.76

* metric thread
 Loose ring flanges 1/2"–2 1/2"
 Integrally molded, fixed flanges 3"–6"

Inch size	Weight PVC/CPVC lbs	Weight PVDF lbs	Weight PP lbs
1/2	1.0	1.3	1.2
3/4	1.5	1.9	1.8
1	2.2	2.6	2.7
1 1/4	3.5	5.1	3.1
1 1/2	4.2	5.1	5.3
2	7.1	8.2	7.9
2 1/2	9.5	12.6	12.0
3	21.4	23.6	19.0
4	30.0	32.8	25.0
6	59.5	68.3	55.2

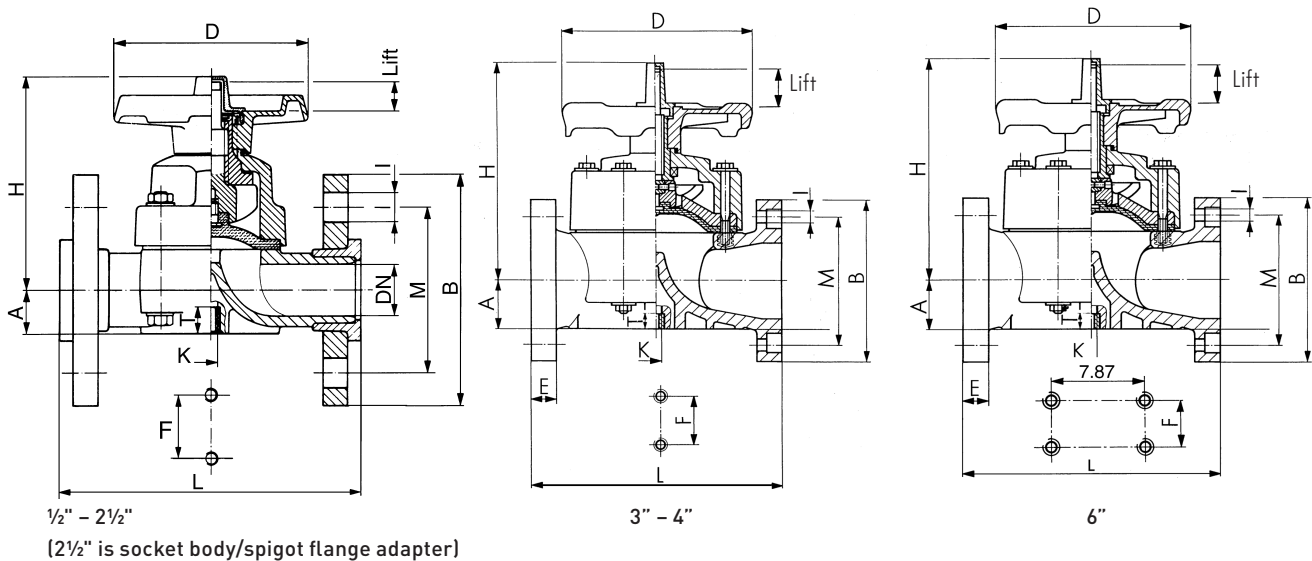

GF Piping Systems → worldwide at home

Our sales companies and representatives ensure local customer support in over 100 countries.

www.piping.georgfischer.com



The technical data is not binding. They neither constitute expressly warranted characteristics nor guaranteed properties nor a guaranteed durability. They are subject to modification. Our General Terms of Sale apply.

Adding Quality to People's Lives

Australia

George Fischer Pty Ltd
Riverwood NSW 2210 Australia
Phone +61(0)2 9502 8000
australia.ps@georgfischer.com
www.georgfischer.com.au

Austria

Georg Fischer
Rohrleitungssysteme GmbH
3130 Herzogenburg
Phone +43(0)2782 856 43-0
austria.ps@georgfischer.com
www.georgfischer.at

Belgium/Luxembourg

Georg Fischer NV/SA
1070 Bruxelles/Brüssel
Phone +32(0)2 556 40 20
be.ps@georgfischer.com
www.georgfischer.be

Brazil

George Fischer Ltda
04795-100 São Paulo
Phone +55(0)11 5687 1311
br.ps@georgfischer.com

Canada

Georg Fischer Piping Systems Ltd
Brampton, ON L6T 4E3
Phone +1(905) 792-8005
ca.ps@georgfischer.com
www.gf.piping.ca

China

Georg Fischer
Piping Systems Ltd Shanghai
Pudong, Shanghai 201319
Phone +86(0)21 58 13 33 33
china.ps@georgfischer.com
www.cn.piping.georgfischer.com

Denmark/Iceland

Georg Fischer A/S
2630 Taastrup
Phone +45 (0)70 22 19 75
info.dk.ps@georgfischer.com
www.georgfischer.dk

France

Georg Fischer SAS
95932 Roissy Charles de Gaulle Cedex
Phone +33(0)1 41 84 68 84
fr.ps@georgfischer.com
www.georgfischer.fr

Germany

Georg Fischer GmbH
73095 Albershausen
Phone +49(0)7161 302-0
info.de.ps@georgfischer.com
www.georgfischer.de

India

Georg Fischer Piping Systems Ltd
400 076 Mumbai
Phone +91 224007 2001
in.ps@georgfischer.com
www.georgfischer.in

Italy

Georg Fischer S.p.A.
20063 Cernusco S/N (MI)
Phone +3902 921 861
it.ps@georgfischer.com
www.georgfischer.it

Japan

Georg Fischer Ltd
556-0011 Osaka,
Phone +81(0)6 6635 2691
jp.ps@georgfischer.com
www.georgfischer.jp

Korea

Georg Fischer Piping Systems
Guro-3 dong, Guro-gu, Seoul, Korea
Phone +82(0)2 2081 1450
Fax +82(0)2 2081 1453
kor.ps@georgfischer.com

Malaysia

Georg Fischer (M) Sdn. Bhd.
40460 Shah Alam, Selangor
Phone +60 (0)3 5122 5585
conne.kong@georgfischer.com

Mexico

Georg Fischer S.A. de C.V.
Apodaca, Nuevo Leon
CP66636 Mexico
Phone +52 (81)1340 8586
Fax +52 (81)1522 8906

Middle East

Georg Fischer Piping Systems
Dubai, United Arab Emirates
Phone +971 4 289 49 60
info.export@georgfischer.com
www.export.georgfischer.com

Netherlands

Georg Fischer N.V.
8161 PA Epe
Phone +31(0)578 678 222
nl.ps@georgfischer.com
www.georgfischer.nl

Norway

Georg Fischer AS
1351 Rud
Phone +47(0)67 18 29 00
no.ps@georgfischer.com
www.georgfischer.no

Poland

Georg Fischer Sp. z o.o.
02-226 Warszawa
Phone +48(0)22 313 10 50
poland.ps@georgfischer.com
www.georgfischer.pl

Romania

Georg Fischer
Piping Systems Ltd
020257 Bucharest - Sector 2
Phone +40(0)21 230 53 80
ro.ps@georgfischer.com
www.export.georgfischer.com

Russia

Georg Fischer Piping Systems
Moscow 125047
Tel. +7 495 258 60 80
ru.ps@georgfischer.com
www.georgfischer.ru

Singapore

George Fischer Pte Ltd
528 872 Singapore
Phone +65(0)67 47 06 11
sgp.ps@georgfischer.com
www.georgfischer.com.sg

Spain/Portugal

Georg Fischer S.A.
28046 Madrid
Phone +34(0)91 781 98 90
es.ps@georgfischer.com
www.georgfischer.es

Sweden/Finland

Georg Fischer AB
12523 Älvsjö-Stockholm
Phone +46(0)8 506 775 00
info.se.ps@georgfischer.com
www.georgfischer.se

Switzerland

Georg Fischer
Rohrleitungssysteme (Schweiz) AG
8201 Schaffhausen
Phone +41(0)52 631 30 26
ch.ps@georgfischer.com
www.piping.georgfischer.ch

Taiwan

Georg Fischer Piping Systems
San Chung City, Taipei Hsien
Phone +886 2 8512 2822
Fax +886 2 8512 2823

United Kingdom/Ireland

George Fischer Sales Limited
Coventry, CV2 2ST
Phone +44(0)2476 535 535
uk.ps@georgfischer.com
www.georgfischer.co.uk

USA/Latin America/Caribbean

Georg Fischer LLC
Tustin, CA 92780-7258
Phone +1(714) 731 88 00
Toll Free 800 854 40 90
us.ps@georgfischer.com
www.us.piping.georgfischer.com